

BLACKBERRY
Q 10
SMARTPHONE

Start Here



To view the Declaration of Conformity made under Directive 1999/5/EC (R&TTE), visit www.blackberry.com/q10declarationofconformity.
Only those files approved by BlackBerry Accessories. The documentation is provided "as is" and without warranty, express or implied. The reproduction or warranty of liability of any kind by Research In Motion Limited and its affiliated companies, all of which are registered trademarks to the maximum extent permitted by applicable law in their respective jurisdictions, is hereby disclaimed.
BlackBerry, Research In Motion, and related trademarks, names and logos are the property of Research In Motion Limited and are registered and/or used in the U.S. and other countries around the world. Angry Birds is a trademark of Rovio Entertainment Ltd. Bluetooth is a trademark of Bluetooth SIG, Inc. The Facebook logo is a trademark of Facebook, Inc. HDMI is a trademark of HDMI Licensing, L.L.C. Kindle is a trademark of Amazon. Touchscreen, the Emerald is a trademark of Emerald Corporation. The National Geographic logo is a trademark of National Geographic Society Corporation. Twitter is a trademark of Twitter, Inc. Wi-Fi is a trademark of the Wi-Fi Alliance. All other trademarks are the property of their respective owners.
MAX-6896-001 REVISED 1/12
1860-201302291241044161 SQN100-1 (RP11111W)
SQN100-2 (RP11111W) SQN100-3 (RP11111W)
SQN100-4 (RP11111W) SQN100-5 (RP11211W)

WELCOME TO YOUR NEW BLACKBERRY!

Built to keep you moving.

Designed with precision for premium performance and an effortless experience.



1. Insert your SIM card, battery, and media card

To remove the battery door, press and slide the battery door down. Insert the micro SIM card. Align the battery contacts to insert the battery. Insert a media card if you have one.

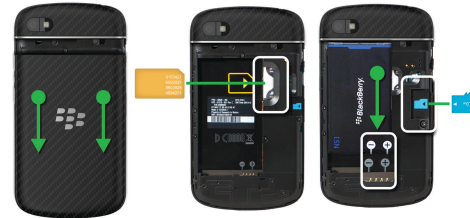

2. Set up your smartphone

1. Press and hold the **Power on/off** key to turn on your smartphone.
2. Follow the instructions on the screen.

After the initial setup, tap **Setup** on the home screen to set up your email, social networking accounts, and BBM. Sign in using your BlackBerry ID or create a BlackBerry ID if you don't have one. BlackBerry ID helps sync information (for example, contacts) between your smartphone and computer. It also manages your apps and services, allowing you to transfer information when you switch smartphones.

For more information about setting up your smartphone, go to www.blackberry.com/startqsetup.

3. Transfer information to your smartphone

With BlackBerry Link, you can bring your contacts, pictures, music, apps, and more from your old smartphone to your new smartphone. Find information about BlackBerry Link at www.blackberry.com/startswitch.

BBM
Share and be seen with BBM Video. Switch from a BBM chat to a BBM Video conversation with Screen Share, to catch up face-to-face and share what's on your screen.
*Wi-Fi, 4G, or HSPA+ connection required.

BlackBerry Balance
Take your smartphone to the office and access work email, apps, and content without compromising the personal use of your smartphone.

BlackBerry World
Discover and share your favorite apps, music, and videos. It's easier than ever.

BlackBerry Remember
Effortlessly create and organize your interests, ideas, and projects in one single location.

BlackBerry Hub

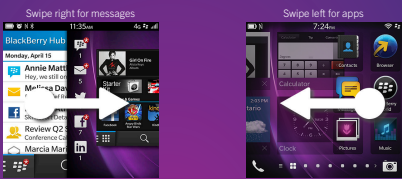

From any app, stay close to what's important with one fast and fluid gesture. Just a swipe to the right lets you peek at the BlackBerry Hub, allowing you to flow in and out of your messages and conversations. Swipe to the left and you have all your apps at your fingertips.

Leave or close an app



You can leave an app just by swiping up. The app is minimized and appears as one of your Active Frames. If you want to close the app completely, tap **X**.

Wake up your smartphone

Swipe up from below the screen and release your finger half-way up. To put your smartphone to sleep, press the **Lock screen** key.

For extra security, you can set a password that you enter when you wake up your smartphone. From the home screen, swipe down from the top of the screen and tap **Settings** > **Security and Privacy** > **Device Password**.



Show menus and more actions

In an app, at the bottom of the screen, tap **≡** or **⋮**. Or, touch and hold an item on the screen.

Safety information

IT IS IMPORTANT THAT YOU READ THE SAFETY AND PRODUCT INFORMATION BOOKLET (INCLUDED) PRIOR TO USING YOUR BLACKBERRY SMARTPHONE. It contains essential safety information related to your smartphone.



Need more help?

Check the Help app on your smartphone, where you can learn tips, tricks, and strategies for getting the most out of your smartphone. Go to these websites for even more support:

Quick start information: www.blackberry.com/startq10

Videos: www.blackberry.com/startvideos

Complete how to: www.blackberry.com/startqdocs

Find information with Search

You can search your smartphone for files, messages, contacts, settings, help, and more from one location. You can even extend your search to include Internet sources. Want to learn more about BlackBerry ID or the Time Shift mode? Search can help you.

1. On the home screen, just type your search term.
2. Tap to focus your search to a particular area.

Check notifications and messages



On the home screen or in an app, slide your finger up from the bottom of the screen and pause. Your notifications appear on the left.

To peek into the BlackBerry Hub to check messages, slide your finger to the right.

To stay in your app, slide your finger to the bottom of the screen.

Change settings



On the home screen, or in some apps, swipe down from the top of the screen. Tap **Settings**.

Accessories

Now that your smartphone is set up, you can protect it with a range of cases, carrying solutions, and skins. Visit your local retailer for authentic BlackBerry accessories, or shop online at www.blackberry.com/startqaccessories.